

Front Elevation

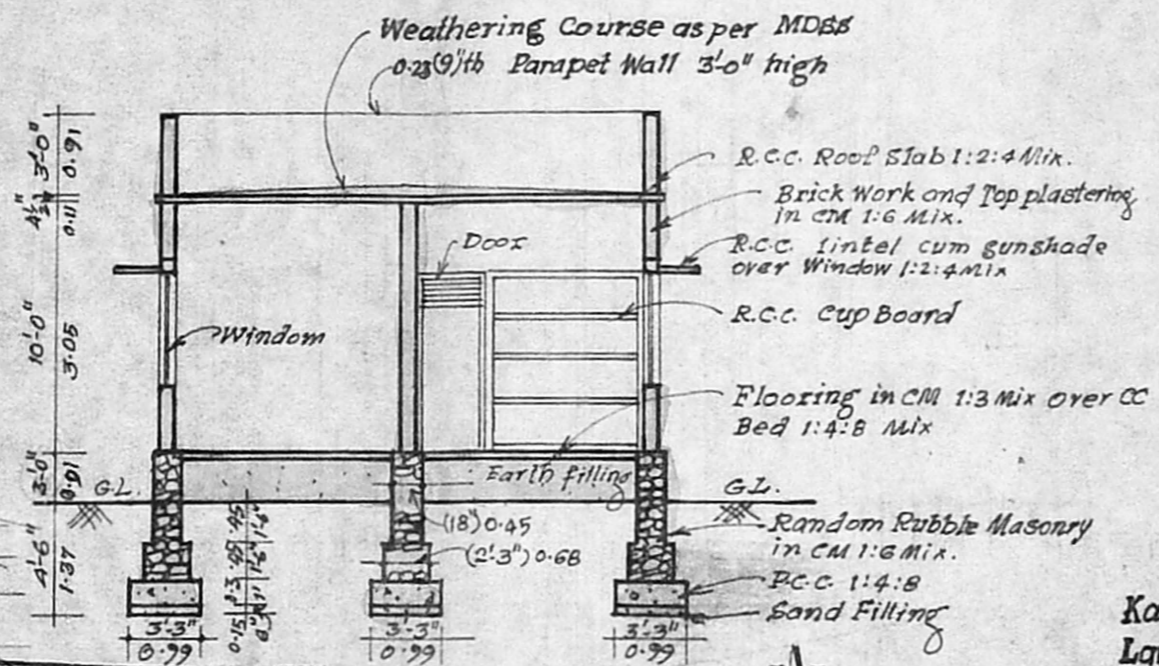

Section on 'AB'

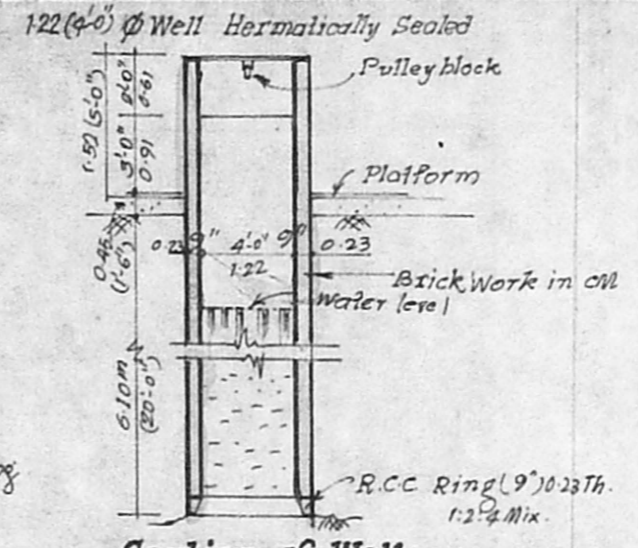

Section of Well



Plan of Well

Kattankolathur Panchayat Union  
Lay out of House Sites in S.No 174 of  
Vandalur Village.

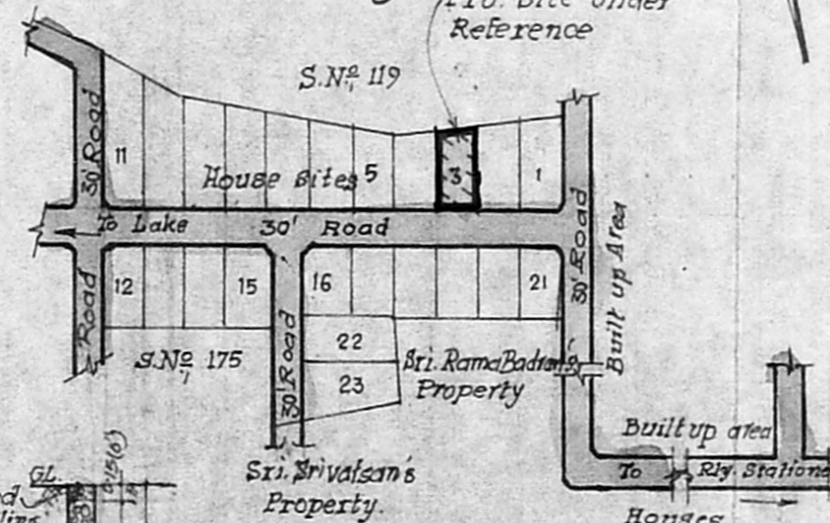

Key Plan

Not to Scale  
Note: Proposed Site Shown in Red

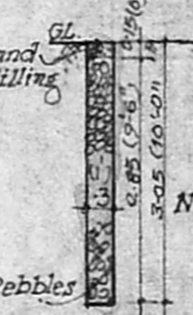

Details of Percolation pit

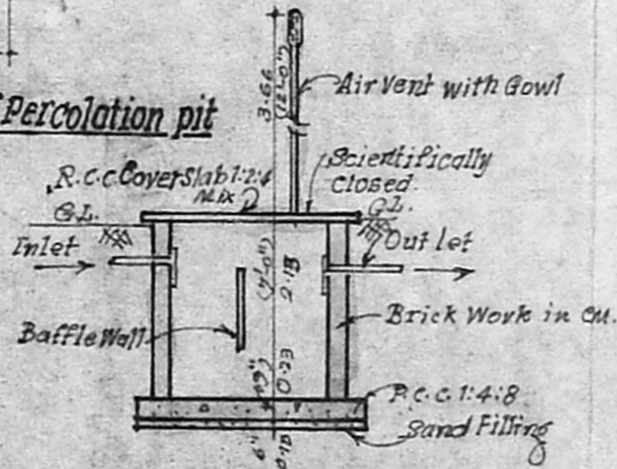

Section Chambers

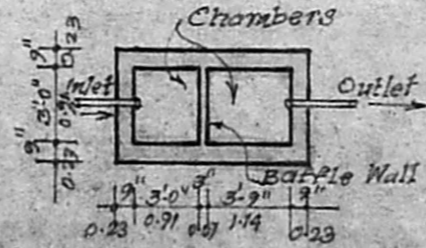

Plan Details of Septic Tank.

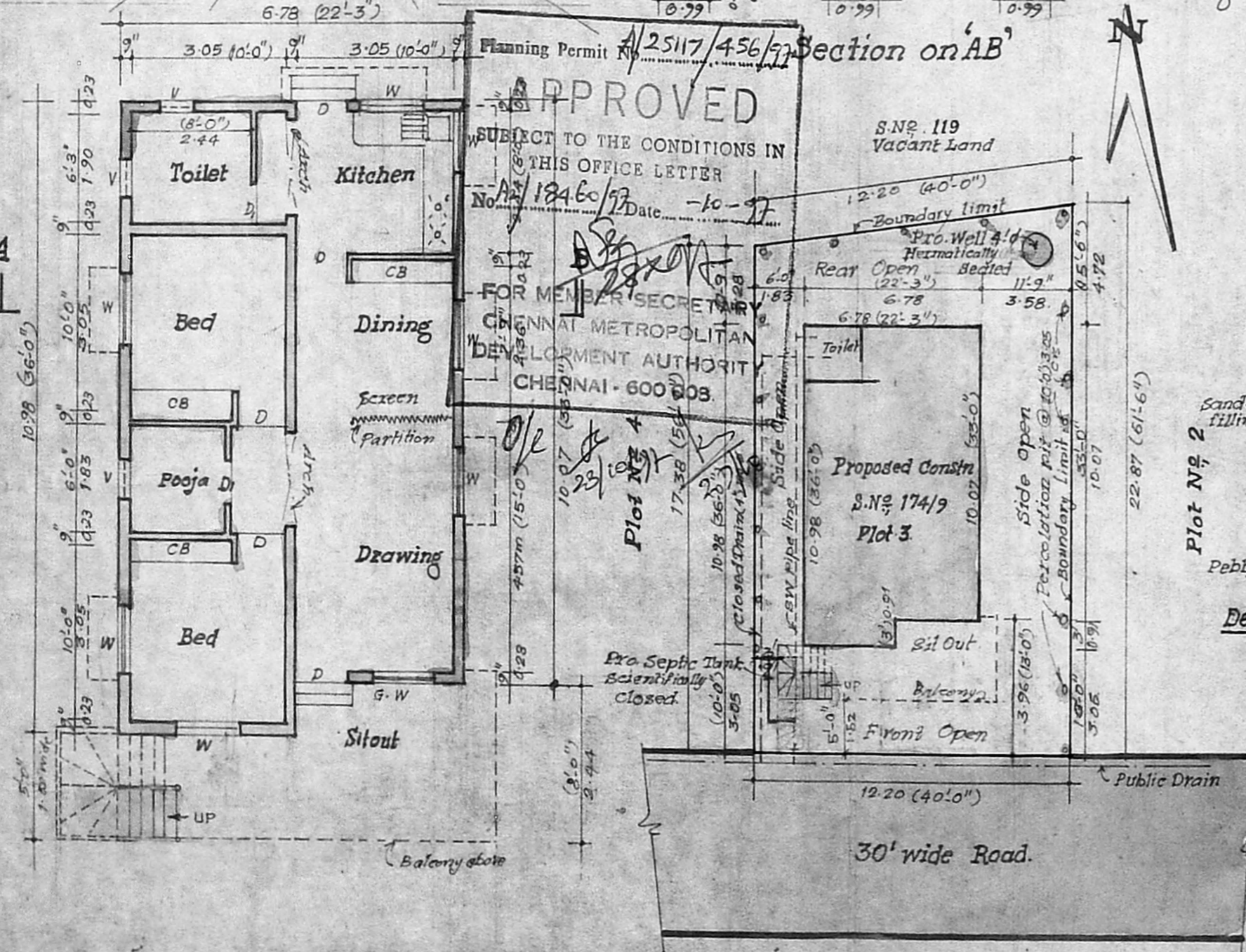

Site Plan

Scale :- 1:200 (1"=16'-0")

Note: Proposals are shown in Red

Plan

Plan showing the Proposed Construction of Dwelling House in Plot No 3 (MMDA approved No. P.P.D/L.O. No. 93/87) in S.No 174/9, in Vandalur village, Kattankolathur Panchayat Union, Chengal-pattu Taluk, MGR Dist.,

Scale :- 1:100 (1"=8'-0")

Owners: sri. R. SRIDHAR % sri M. Radhakrishnan  
Smt. V. PADMA % R. Sridhar Naidu.

Particulars of Site

Total Area of Site	219.70 m <sup>2</sup>	2365 Sft
Plinth Area of Pro. Constn	71.40 "	768.75 "
Carpet Area "	59.42 "	634.59 "
Area of Open Space	148.30 "	1596.25 "
Plot Coverage - 32.5%	F.S.I - 32 Times	

Joinery Schedule

Ref	Description.	Size	
		in metre	ft & inches
D	Door	0.99 x 2.13	3'-3" x 7'-0"
D1	"	0.76 x 1.98	2'-6" x 6'-6"
W	Window	1.22 x 1.37	4'-0" x 4'-6"
V	Ventilator	0.91 x 0.45	3'-0" x 1'-6"
CB	Cup Board	1.98 x 1.98	6'-6" x 6'-6"
GW	Grilled Work (Enclosures)	as reqd.	as reqd.

Colour Index.

Proposals shown thus	<span style="border: 1px solid red; display: inline-block; width: 15px; height: 10px;"></span> Red
Boundary limit "	<span style="border-bottom: 1px solid black; display: inline-block; width: 20px;"></span> Black.
Roads "	<span style="border-bottom: 1px solid green; display: inline-block; width: 20px;"></span> Green

Note:-  
1. All dimensions are in metres (ft & inches)

Owners:-

1. R. Sridhar.

2. V. Padma.

Prepared by:-

*K. Selvam*  
K. SELVAM, B.E., A.M.I.E.,  
Consulting Civil Engineer, Chartered Engineer,  
Class - I Licensed Surveyor, Reg. No: 800  
Corporation of Chennai & Ambattur Municipal  
No: 1/370, Mogappair East,  
CHENNAI-600 050.

*V. Padma*